

5. Exploded View & Part List

5-1. LS19CMYKF/ZC - Exploded View (933SN)

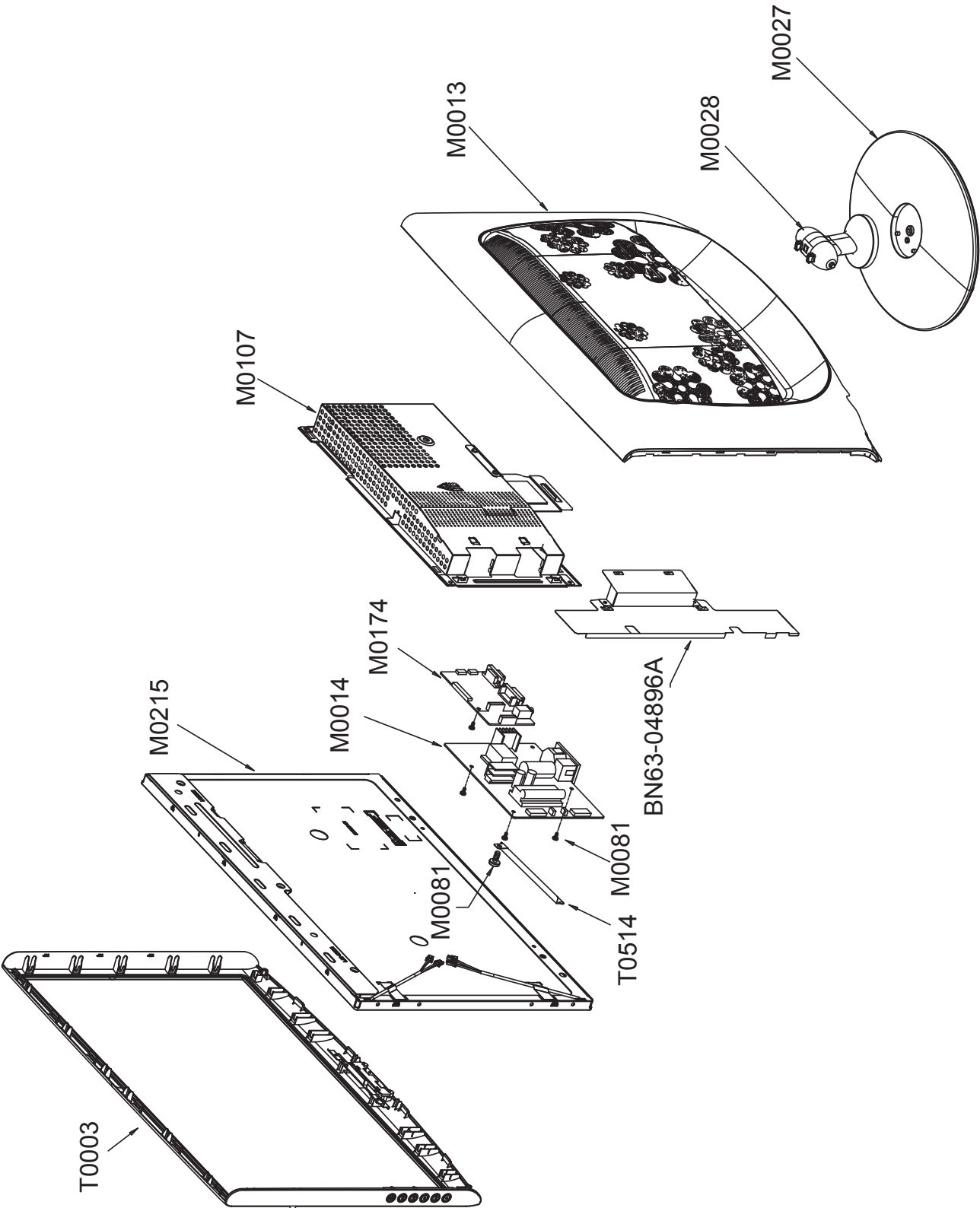

5-1-1. LS19CMYKF/ZC - Parts List

Location No.	Code No.	Description & Specification	Q'ty	SA/SNA	Remark
M0013	BN96-08341A	ASSY COVER P-REAR;CREAM 933SN,ABS+PMMA,H	1	S.A	
M0014	BN94-02051Q	ASSY PCB MAIN-PTZ;LS19CMYKF/UF	1	S.A	
M0027	BN96-08556A	ASSY STAND P-BASE;Cream-MFM 18.5,ABS HB,	1	S.A	
M0028	BN96-08101A	ASSY STAND P-BAR;2233BW,,ABS HB,BK23,GLO	1	S.A	
M0081	6003-000115	SCREW-TAPTITE;BH,+,B,M3,L6,ZPC(BLK),SWRC	3	S.N.A	
M0081	6003-000115	SCREW-TAPTITE;BH,+,B,M3,L6,ZPC(BLK),SWRC	1	S.N.A	
M0081	6003-001439	SCREW-TAPTITE;BH,+,-,S,M4,L8,ZPC(WHT),SW	1	S.N.A	
M0107	BN63-04894A	SHIELD-COVER;Cream 933SN,SECC,T0.8	1	S.N.A	
M0174	BN44-00249A	IP BOARD;IP-20145A,Cream933SN(2LAMP),0.7	1	S.A	
M0215	BN07-00584A	LCD-PANEL;CLAA185WA02	1	S.A	
T0003	BN96-08342D	ASSY COVER P-FRONT;933,ABS,HB,HIGH GLOSS	1	S.A	
T0514	BN61-03557A	BRACKET-SUPPORT;2043BW/NW[Mckinley],SPTE	1	S.N.A	
	BN63-04896A	SHIELD-LAMP;Cream 933SN,SPTE,T0.3,-,-,-,	1	S.N.A	

5-2. LS19CMYKF/ZC - Parts List

Service Bom (SA: SERVICE AVAILABLE, SNA: SERVICE NOT AVAILABLE)

Level	Location No.	Code No.	Description & Specification	Q'ty	SA/SNA	Remark
		LS19CMYKF/ZC	933SN,WVG1/S19R3-LCM,19,LCD-MO,CANADA			
0.1	M0001	BN90-01807A	ASSY COVER FRONT;LS19CMYKF,BLACK,HIGH GL	1	S.N.A	
..2	T0003	BN96-08342D	ASSY COVER P-FRONT;933,ABS,HB,HIGH GLOSS	1	S.A	
...3	M0081	6003-000282	SCREW-TAPTITE;BH,+,-,B,M3,L8,ZPC(BLK),SW	2	S.N.A	
...3		BN61-04252A	HOLDER-LED PCB;2233BW,ABS HB,BK23	1	S.N.A	
...3		BN61-04293A	GUIDE-PANEL;2233BW,SECC,T0.5	1	S.N.A	
...3	CCM1	BN63-02183D	COVER-SHEET;Rhcm,PE Vinyl,T0.05,680mm,20	0.5	S.N.A	
...3	M0112	BN63-04888D	COVER-FRONT;933,ABS,HB,BLACK,High/Glossy	1	S.N.A	
...3	M0007	BN64-00927A	KNOB-FUNCTION;2233BW,ABS,HB,BK23,Glossy	1	S.N.A	
...3	M0105	BN67-00229A	LENS-LED;2233BW,PC,TP26	1	S.N.A	
...3	M0145	BN96-08542C	ASSY BOARD P-FUNCTION;Cream_19,SJ08-01-0	1	S.A	
....4		BN94-02089C	ASSY PCB MAIN-FUNCTION/PCB;CREAM,FUNCTIO	1	S.N.A	
.....5	M2893	BN39-01119A	LEAD CONNECTOR;Cream19',UL1061#28,UL,4P/	1	S.A	
.....5		BN97-02501A	ASSY SMD-F/PCB;CREAM,FUNCTION Assy	1	S.N.A	
.....6	R3	2007-000081	R-CHIP;2.7Kohm,5%,1/10W,TP,1608	1	S.N.A	
.....6	R4	2007-000081	R-CHIP;2.7Kohm,5%,1/10W,TP,1608	1	S.N.A	
.....6	R1	2007-000123	R-CHIP;1.5Kohm,5%,1/10W,TP,1608	1	S.N.A	
.....6	R2	2007-000123	R-CHIP;1.5Kohm,5%,1/10W,TP,1608	1	S.N.A	
.....6	T0313	3404-001209	SWITCH-TACT;12VDC,50mA,250gf,4.5x4.5x1.5	1	S.A	
.....6	T0313	3404-001209	SWITCH-TACT;12VDC,50mA,250gf,4.5x4.5x1.5	1	S.A	
.....6	T0313	3404-001209	SWITCH-TACT;12VDC,50mA,250gf,4.5x4.5x1.5	1	S.A	
.....6	T0313	3404-001209	SWITCH-TACT;12VDC,50mA,250gf,4.5x4.5x1.5	1	S.A	
.....6	T0313	3404-001209	SWITCH-TACT;12VDC,50mA,250gf,4.5x4.5x1.5	1	S.A	
.....6	T0313	3404-001209	SWITCH-TACT;12VDC,50mA,250gf,4.5x4.5x1.5	1	S.A	
.....6	CN330	3711-005543	HEADER-BOARD TO CABLE;BOX,6P,1R,1.25mm,S	1	S.N.A	
.....6	PCB	BN41-01084A	PCB SUB-FUNCTION;CREAM function,FR-1,1,	1	S.N.A	
.....5		BN97-02501B	ASSY SMD-LDE/PCB;CREAM,LED Assy	1	S.N.A	
.....6	L0405	0601-001896	LED;SMD,BLUE,1.6x0.8x0.4mm,470,1.6x0.8x0	1	S.N.A	
.....6	L0405	0601-001896	LED;SMD,BLUE,1.6x0.8x0.4mm,470,1.6x0.8x0	1	S.N.A	
.....6	CN330	3711-000541	HEADER-BOARD TO CABLE;BOX,2P,1R,1.25mm,S	1	S.N.A	
.....6	PCB	BN41-01083A	PCB SUB-LED;CREAM,FR-1,1,1.0,1.6,8.8*67.	1	S.N.A	
0.1	M0002	BN90-01808A	ASSY COVER REAR;LS19CMYKF,BLACK,HIGH GLO	1	S.N.A	
..2	M0081	6003-000275	SCREW-TAPTITE;BH,+,-,B,M3,L10,ZPC(BLK),S	2	S.N.A	
..2	M0013	BN96-08341A	ASSY COVER P-REAR;CREAM 933SN,ABS+PMMA,H	1	S.A	
...3	M0081	6003-001003	SCREW-TAPTITE;BH,+,-,B,M4,L12,ZPC(BLK),S WR	4	S.N.A	
...3	M0113	BN61-01581A	BRACKET-VESA;BI17/19BS,SECC,T1.0	2	S.N.A	

5. Exploded View & Part List

Level	Location No.	Code No.	Description & Specification	Q'ty	SA/SNA	Remark
...3	T0060	BN61-02830A	SPRING ETC;PEBBLE,SK5,1.0,LS19PEB,HRC 45	1	S.N.A	
...3	CCM1	BN63-02183D	COVER-SHEET;Rhcm,PE Vinyl,T0.05,680mm,20	0.5	S.N.A	
...3	T0056	BN63-04685A	COVER-DECORATION;933BW/933NW/ 933GW,PC,-,	1	S.N.A	
...3	M0014	BN63-04687A	COVER-STAND BAR;2233BW,ABS,HB,BK23	1	S.N.A	
...3		BN63-04688A	COVER-HINGE;2233BW,ABS,HB,BK23	1	S.N.A	
...3	M0006	BN63-04893A	COVER-REAR;CREAM 933SN,ABS+PMMA,HB,BK23,	1	S.N.A	
...3	T0102	BN73-00179A	RUBBER-CAP;2233BW,ELASTOMER HB,BK07	1	S.N.A	
0.1	M0017	BN91-02548Q	ASSY CHASSIS-PTZ;LS19CMYKF/UF	1	S.N.A	
..2	M0081	6003-000115	SCREW-TAPTITE;BH,+,B,M3,L6,ZPC(BLK),SW RC	3	S.N.A	
..2	M0081	6003-000115	SCREW-TAPTITE;BH,+,B,M3,L6,ZPC(BLK),SW RC	1	S.N.A	
..2	M0081	6003-001439	SCREW-TAPTITE;BH,+,S,M4,L8,ZPC(WHT),SW	1	S.N.A	
..2	M0174	BN44-00249A	IP BOARD;IP-20145A,Cream933SN(2LAMP),0.7	1	S.A	
..2	T0514	BN61-03557A	BRACKET-SUPPORT;2043BW/ NW[Mckinley],SPTe	1	S.N.A	
..2	M0014	BN94-02051Q	ASSY PCB MAIN-PTZ;LS19CMYKF/UF	1	S.A	
...3	T0245	0202-001608	SOLDER-WIRE FLUX;LFC7-107,D0.8,99.3Sn/0.	0.003	S.N.A	
...3	CN101	3701-001219	CONNECTOR-DSUB;15P,3R,FEMALE,ANGLE, AUF	1	S.A	
...3		BN97-02433Q	ASSY SMD-PTZ;LS19CMYKF/UF	1	S.N.A	
....4	SUB05	0202-001477	SOLDER-CREAM;LST309-M,-,D20~45um,96.5Sn/	0.79	S.N.A	
....4	D108	0401-001056	DIODE-SWITCHING;MMBD4148SE,100V,200m A,SO	1	S.A	
....4	D109	0401-001056	DIODE-SWITCHING;MMBD4148SE,100V,200m A,SO	1	S.A	
....4	D110	0401-001056	DIODE-SWITCHING;MMBD4148SE,100V,200m A,SO	1	S.A	
....4	D600	0402-001614	DIODE-RECTIFIER;S1G,400V,1A,DO-214AC,TP	1	S.A	
....4	D601	0402-001614	DIODE-RECTIFIER;S1G,400V,1A,DO-214AC,TP	1	S.A	
....4	ZD104	0403-001411	DIODE-ZENER;-5.49-5.73V,200mW,SOD-323,T	1	S.N.A	
....4	ZD105	0403-001411	DIODE-ZENER;-5.49-5.73V,200mW,SOD-323,T	1	S.N.A	
....4	ZD202	0403-001411	DIODE-ZENER;-5.49-5.73V,200mW,SOD-323,T	1	S.N.A	
....4	ZD203	0403-001411	DIODE-ZENER;-5.49-5.73V,200mW,SOD-323,T	1	S.N.A	
....4	ZD204	0403-001411	DIODE-ZENER;-5.49-5.73V,200mW,SOD-323,T	1	S.N.A	
....4	ZD601	0403-001411	DIODE-ZENER;-5.49-5.73V,200mW,SOD-323,T	1	S.N.A	
....4	ZD201	0406-001061	DIODE-TVS;MMQA5V6T3,5.32/5.6/5.88V,24W,S	1	S.A	
....4	Q203	0501-000445	TR-SMALL SIGNAL;KTC3875S- Y,NPN,150mW,SOT	1	S.A	
....4	Q204	0501-000445	TR-SMALL SIGNAL;KTC3875S- Y,NPN,150mW,SOT	1	S.A	
....4	Q601	0501-000445	TR-SMALL SIGNAL;KTC3875S- Y,NPN,150mW,SOT	1	S.A	
....4	Q202	0501-002080	TR-SMALL SIGNAL;2SC2412K,NPN,200mW,SC- 59	1	S.A	
....4	Q205	0501-002080	TR-SMALL SIGNAL;2SC2412K,NPN,200mW,SC- 59	1	S.A	
....4	Q409	0505-001165	FET-SILICON;SI3443BDV,P,-20V,+4.4A,65mo	1	S.A	
....4	IC112	1103-001410	IC-EEPROM;S-24CS08AFJ-TB-1GE,8Kbit,1Kx8,	1	S.A	
....4	T0087	1203-003695	IC-POSIFIXED REG.;NCP1117ST33T3G,SOT-22	1	S.A	
....4	T0087	1203-003696	IC-POSIFIXED REG.;NCP1117DT18T5G,DPAK,3	1	S.A	

5. Exploded View & Part List

Level	Location No.	Code No.	Description & Specification	Q'ty	SA/SNA	Remark
....4	IC109	1205-003364	IC-LCD CONTROLLER;SE717M-LF,PQFP,128P,20	1	S.A	
....4	R111	2007-000074	R-CHIP;100ohm,5%,1/10W,TP,1608	1	S.A	
....4	R113	2007-000074	R-CHIP;100ohm,5%,1/10W,TP,1608	1	S.A	
....4	R114	2007-000074	R-CHIP;100ohm,5%,1/10W,TP,1608	1	S.A	
....4	R117	2007-000074	R-CHIP;100ohm,5%,1/10W,TP,1608	1	S.A	
....4	R118	2007-000074	R-CHIP;100ohm,5%,1/10W,TP,1608	1	S.A	
....4	R120	2007-000074	R-CHIP;100ohm,5%,1/10W,TP,1608	1	S.A	
....4	R206	2007-000074	R-CHIP;100ohm,5%,1/10W,TP,1608	1	S.A	
....4	R207	2007-000074	R-CHIP;100ohm,5%,1/10W,TP,1608	1	S.A	
....4	R212	2007-000074	R-CHIP;100ohm,5%,1/10W,TP,1608	1	S.A	
....4	R213	2007-000074	R-CHIP;100ohm,5%,1/10W,TP,1608	1	S.A	
....4	R230	2007-000074	R-CHIP;100ohm,5%,1/10W,TP,1608	1	S.A	
....4	R245	2007-000074	R-CHIP;100ohm,5%,1/10W,TP,1608	1	S.A	
....4	R250	2007-000074	R-CHIP;100ohm,5%,1/10W,TP,1608	1	S.A	
....4	R251	2007-000074	R-CHIP;100ohm,5%,1/10W,TP,1608	1	S.A	
....4	R252	2007-000074	R-CHIP;100ohm,5%,1/10W,TP,1608	1	S.A	
....4	R255	2007-000074	R-CHIP;100ohm,5%,1/10W,TP,1608	1	S.A	
....4	R123	2007-000080	R-CHIP;2Kohm,5%,1/10W,TP,1608	1	S.N.A	
....4	R270	2007-000080	R-CHIP;2Kohm,5%,1/10W,TP,1608	1	S.N.A	
....4	R208	2007-000082	R-CHIP;3.3Kohm,5%,1/10W,TP,1608	1	S.N.A	
....4	R209	2007-000082	R-CHIP;3.3Kohm,5%,1/10W,TP,1608	1	S.N.A	
....4	R218	2007-000083	R-CHIP;3Kohm,5%,1/10W,TP,1608	1	S.N.A	
....4	R229	2007-000083	R-CHIP;3Kohm,5%,1/10W,TP,1608	1	S.N.A	
....4	R219	2007-000084	R-CHIP;4.7Kohm,5%,1/10W,TP,1608	1	S.A	
....4	R223	2007-000084	R-CHIP;4.7Kohm,5%,1/10W,TP,1608	1	S.A	
....4	R600	2007-000088	R-CHIP;7.5Kohm,5%,1/10W,TP,1608	1	S.N.A	
....4	R126	2007-000090	R-CHIP;10Kohm,5%,1/10W,TP,1608	1	S.A	
....4	R130	2007-000090	R-CHIP;10Kohm,5%,1/10W,TP,1608	1	S.A	
....4	R131	2007-000090	R-CHIP;10Kohm,5%,1/10W,TP,1608	1	S.A	
....4	R210	2007-000090	R-CHIP;10Kohm,5%,1/10W,TP,1608	1	S.A	
....4	R211	2007-000090	R-CHIP;10Kohm,5%,1/10W,TP,1608	1	S.A	
....4	R214	2007-000090	R-CHIP;10Kohm,5%,1/10W,TP,1608	1	S.A	
....4	R217	2007-000090	R-CHIP;10Kohm,5%,1/10W,TP,1608	1	S.A	
....4	R222	2007-000090	R-CHIP;10Kohm,5%,1/10W,TP,1608	1	S.A	
....4	R224	2007-000090	R-CHIP;10Kohm,5%,1/10W,TP,1608	1	S.A	
....4	R226	2007-000090	R-CHIP;10Kohm,5%,1/10W,TP,1608	1	S.A	
....4	R233	2007-000090	R-CHIP;10Kohm,5%,1/10W,TP,1608	1	S.A	
....4	R236	2007-000090	R-CHIP;10Kohm,5%,1/10W,TP,1608	1	S.A	
....4	R253	2007-000090	R-CHIP;10Kohm,5%,1/10W,TP,1608	1	S.A	
....4	R271	2007-000090	R-CHIP;10Kohm,5%,1/10W,TP,1608	1	S.A	
....4	R601	2007-000090	R-CHIP;10Kohm,5%,1/10W,TP,1608	1	S.A	
....4	R602	2007-000090	R-CHIP;10Kohm,5%,1/10W,TP,1608	1	S.A	
....4	R612	2007-000090	R-CHIP;10Kohm,5%,1/10W,TP,1608	1	S.A	
....4	R225	2007-000102	R-CHIP;100Kohm,5%,1/10W,TP,1608	1	S.A	
....4	R125	2007-000124	R-CHIP;2.2Kohm,5%,1/10W,TP,1608	1	S.N.A	
....4	R232	2007-000309	R-CHIP;10ohm,5%,1/10W,TP,1608	1	S.A	
....4	R273	2007-000309	R-CHIP;10ohm,5%,1/10W,TP,1608	1	S.A	
....4	R116	2007-000821	R-CHIP;390ohm,1%,1/10W,TP,1608	1	S.N.A	
....4	R235	2007-000821	R-CHIP;390ohm,1%,1/10W,TP,1608	1	S.N.A	
....4	R121	2007-001044	R-CHIP;56ohm,5%,1/10W,TP,1608	1	S.A	

5. Exploded View & Part List

Level	Location No.	Code No.	Description & Specification	Q'ty	SA/SNA	Remark
....4	R122	2007-001044	R-CHIP;56ohm,5%,1/10W,TP,1608	1	S.A	
....4	R112	2007-001164	R-CHIP;75ohm,1%,1/10W,TP,1608	1	S.N.A	
....4	R115	2007-001164	R-CHIP;75ohm,1%,1/10W,TP,1608	1	S.N.A	
....4	R119	2007-001164	R-CHIP;75ohm,1%,1/10W,TP,1608	1	S.N.A	
....4	R603	2007-002425	R-CHIP;1ohm,5%,1/10W,TP,1608	1	S.N.A	
....4	R604	2007-002425	R-CHIP;1ohm,5%,1/10W,TP,1608	1	S.N.A	
....4	C201	2203-000236	C-CER,CHIP;0.1nF,5%,50V,C0G,1608	1	S.N.A	
....4	C202	2203-000236	C-CER,CHIP;0.1nF,5%,50V,C0G,1608	1	S.N.A	
....4	C229	2203-000236	C-CER,CHIP;0.1nF,5%,50V,C0G,1608	1	S.N.A	
....4	C109	2203-000257	C-CER,CHIP;10nF,10%,50V,X7R,TP,1608	1	S.A	
....4	C218	2203-000257	C-CER,CHIP;10nF,10%,50V,X7R,TP,1608	1	S.A	
....4	C221	2203-000257	C-CER,CHIP;10nF,10%,50V,X7R,TP,1608	1	S.A	
....4	C116	2203-000384	C-CER,CHIP;0.015nF,5%,50V,C0G,1608	1	S.N.A	
....4	C115	2203-000626	C-CER,CHIP;0.022nF,5%,50V,C0G,1608	1	S.N.A	
....4	C210	2203-000626	C-CER,CHIP;0.022nF,5%,50V,C0G,1608	1	S.N.A	
....4	C211	2203-000626	C-CER,CHIP;0.022nF,5%,50V,C0G,1608	1	S.N.A	
....4	C106	2203-000888	C-CER,CHIP;4.7nF,10%,50V,X7R,TP,1608	1	S.A	
....4	C107	2203-000888	C-CER,CHIP;4.7nF,10%,50V,X7R,TP,1608	1	S.A	
....4	C108	2203-000888	C-CER,CHIP;4.7nF,10%,50V,X7R,TP,1608	1	S.A	
....4	C110	2203-000888	C-CER,CHIP;4.7nF,10%,50V,X7R,TP,1608	1	S.A	
....4	C111	2203-000888	C-CER,CHIP;4.7nF,10%,50V,X7R,TP,1608	1	S.A	
....4	C112	2203-000888	C-CER,CHIP;4.7nF,10%,50V,X7R,TP,1608	1	S.A	
....4	C117	2203-005005	C-CER,CHIP;100nF,10%,16V,X7R,1608	1	S.A	
....4	C124	2203-005005	C-CER,CHIP;100nF,10%,16V,X7R,1608	1	S.A	
....4	C125	2203-005005	C-CER,CHIP;100nF,10%,16V,X7R,1608	1	S.A	
....4	C204	2203-005005	C-CER,CHIP;100nF,10%,16V,X7R,1608	1	S.A	
....4	C205	2203-005005	C-CER,CHIP;100nF,10%,16V,X7R,1608	1	S.A	
....4	C206	2203-005005	C-CER,CHIP;100nF,10%,16V,X7R,1608	1	S.A	
....4	C209	2203-005005	C-CER,CHIP;100nF,10%,16V,X7R,1608	1	S.A	
....4	C212	2203-005005	C-CER,CHIP;100nF,10%,16V,X7R,1608	1	S.A	
....4	C213	2203-005005	C-CER,CHIP;100nF,10%,16V,X7R,1608	1	S.A	
....4	C222	2203-005005	C-CER,CHIP;100nF,10%,16V,X7R,1608	1	S.A	
....4	C230	2203-005005	C-CER,CHIP;100nF,10%,16V,X7R,1608	1	S.A	
....4	C234	2203-005005	C-CER,CHIP;100nF,10%,16V,X7R,1608	1	S.A	
....4	C600	2203-005005	C-CER,CHIP;100nF,10%,16V,X7R,1608	1	S.A	
....4	C601	2203-005005	C-CER,CHIP;100nF,10%,16V,X7R,1608	1	S.A	
....4	C603	2203-005005	C-CER,CHIP;100nF,10%,16V,X7R,1608	1	S.A	
....4	C604	2203-005005	C-CER,CHIP;100nF,10%,16V,X7R,1608	1	S.A	
....4	C605	2203-005005	C-CER,CHIP;100nF,10%,16V,X7R,1608	1	S.A	
....4	C610	2203-005005	C-CER,CHIP;100nF,10%,16V,X7R,1608	1	S.A	
....4	C612	2203-005005	C-CER,CHIP;100nF,10%,16V,X7R,1608	1	S.A	
....4	C613	2203-005005	C-CER,CHIP;100nF,10%,16V,X7R,1608	1	S.A	
....4	C614	2203-005005	C-CER,CHIP;100nF,10%,16V,X7R,1608	1	S.A	
....4	C617	2203-005005	C-CER,CHIP;100nF,10%,16V,X7R,1608	1	S.A	
....4	C618	2203-005005	C-CER,CHIP;100nF,10%,16V,X7R,1608	1	S.A	
....4	C619	2203-005005	C-CER,CHIP;100nF,10%,16V,X7R,1608	1	S.A	
....4	C620	2203-005005	C-CER,CHIP;100nF,10%,16V,X7R,1608	1	S.A	
....4	C621	2203-005005	C-CER,CHIP;100nF,10%,16V,X7R,1608	1	S.A	
....4	C622	2203-005005	C-CER,CHIP;100nF,10%,16V,X7R,1608	1	S.A	
....4	C623	2203-005005	C-CER,CHIP;100nF,10%,16V,X7R,1608	1	S.A	
....4	C626	2203-005005	C-CER,CHIP;100nF,10%,16V,X7R,1608	1	S.A	

5. Exploded View & Part List

Level	Location No.	Code No.	Description & Specification	Q'ty	SA/SNA	Remark
....4	C627	2203-005005	C-CER,CHIP;100nF,10%,16V,X7R,1608	1	S.A	
....4	C628	2203-005005	C-CER,CHIP;100nF,10%,16V,X7R,1608	1	S.A	
....4	C630	2203-005005	C-CER,CHIP;100nF,10%,16V,X7R,1608	1	S.A	
....4	C631	2203-005005	C-CER,CHIP;100nF,10%,16V,X7R,1608	1	S.A	
....4	C632	2203-005005	C-CER,CHIP;100nF,10%,16V,X7R,1608	1	S.A	
....4	C635	2203-005005	C-CER,CHIP;100nF,10%,16V,X7R,1608	1	S.A	
....4	C636	2203-005005	C-CER,CHIP;100nF,10%,16V,X7R,1608	1	S.A	
....4	C637	2203-005005	C-CER,CHIP;100nF,10%,16V,X7R,1608	1	S.A	
....4	C638	2203-005005	C-CER,CHIP;100nF,10%,16V,X7R,1608	1	S.A	
....4	C640	2203-005005	C-CER,CHIP;100nF,10%,16V,X7R,1608	1	S.A	
....4	C641	2203-005005	C-CER,CHIP;100nF,10%,16V,X7R,1608	1	S.A	
....4	C208	2203-005065	C-CER,CHIP;1000nF,+80-20%,10V,Y5V,1608	1	S.N.A	
....4	C220	2203-005065	C-CER,CHIP;1000nF,+80-20%,10V,Y5V,1608	1	S.N.A	
....4	C228	2203-005065	C-CER,CHIP;1000nF,+80-20%,10V,Y5V,1608	1	S.N.A	
....4	C207	2203-005437	C-CER,CHIP;10000nF,+80-20%,10V,Y5V,3216	1	S.N.A	
....4	C223	2203-005437	C-CER,CHIP;10000nF,+80-20%,10V,Y5V,3216	1	S.N.A	
....4	C602	2203-005437	C-CER,CHIP;10000nF,+80-20%,10V,Y5V,3216	1	S.N.A	
....4	C606	2203-005437	C-CER,CHIP;10000nF,+80-20%,10V,Y5V,3216	1	S.N.A	
....4	X202	2801-003667	CRYSTAL-SMD;14.31818MHz,30ppm,28-AAN,16p	1	S.A	
....4	T0568	3301-001407	BEAD-SMD;30ohm,1608,300mA,TP,,,0.4ohm	1	S.N.A	
....4	T0568	3301-001407	BEAD-SMD;30ohm,1608,300mA,TP,,,0.4ohm	1	S.N.A	
....4	M0106	3708-001150	CONNECTOR-FPC/FFC/PIC;30P,1mm,SMD-A,SN,Y	1	S.A	
....4	T0077	BN41-01097A	PCB MAIN;LS19CMY(933SN),CEM-3,2,MP1.0,1.	1	S.N.A	
....4	M0018	BN97-02430P	ASSY MICOM;Cream,LCM19YS,MX25L1005,2008.	1	S.N.A	
.....5	IC115	1107-001614	IC-FLASH MEMORY;MX25L1005,1Mbit,1Mx1Bit,	1	S.N.A	
....4	BD104	2007-000070	R-CHIP;0ohm,5%,1/10W,TP,1608	1	S.N.A	
...3	CN330	3711-003844	HEADER-BOARD TO CABLE;BOX,12P,1R,2mm,STR	1	S.N.A	
..2	M0006	BN96-08350A	ASSY SHIELD P-COVER;CREAM 933SN,SECC,T0.	1	S.N.A	
...3		BN61-02429D	STUD-PEM;PNB,M2.8,D7,L20,ZPC(SIL),SUM24L	1	S.N.A	
...3	T0103	BN61-04426A	BRACKET-FRAME;Cream 933SN,SECC,T0.8,-,-,	1	S.N.A	
...3	M0107	BN63-04894A	SHIELD-COVER;Cream 933SN,SECC,T0.8	1	S.N.A	
..2	M0251	BN96-02854N	ASSY CABLE P;Fininfarina,FLAT CABLE,-,15	1	S.A	
0.1	M0135	BN91-02732A	ASSY LCD-PTZ;LS19CM*	1	S.N.A	
..2	M0215	BN07-00584A	LCD-PANEL;CLAA185WA02	1	S.A	
0.1	M0112	BN91-02733A	ASSY SHIELD;LS19CMYKF(933SN)	1	S.N.A	
..2		BN63-04896A	SHIELD-LAMP;Cream 933SN,SPTE,T0.3,-,-,-,	1	S.N.A	
0.1	M0113	BN92-03663J	ASSY P/MATERIAL;LS19CMYKF/UF	1	S.N.A	
..2	T0376	6902-000061	BAG AIR;LDPE,T0.2,W500,L1000,TRP,-,-,-,3	0.004	S.N.A	
..2	T0524	6902-000241	BAG PE;HDPE/NITRON,T0.5/T0.012,W600,L600	1	S.N.A	
..2	T0376	6902-000379	BAG AIR;LDPE,T0.2,W1000,L1800,TRP,-,-,-,	0.001	S.N.A	
..2	T0003	6902-000604	BAG WRAPPING;LDPE,T0.02,W500,L10000,TRP,	0.8	S.N.A	
..2	M0081	6902-000609	BAG ROLL;LDPE,T0.05,W2400,L1000,TRP,-,-,	0.018	S.N.A	
0.1	M0019	BN92-03664C	ASSY LABEL;LS22CMKKFV/ZA	1	S.N.A	

5. Exploded View & Part List

Level	Location No.	Code No.	Description & Specification	Q'ty	SA/SNA	Remark
0.1	M0045	BN92-03979F	ASSY ACCESSORY;LS19CMYKF/ZA	1	S.N.A	
..2	M0114	BN39-00244G	CBF SIGNAL;D-sub cable,15P/15P,20276N,15	1	S.A	
..2	M0028	BN96-08101A	ASSY STAND P-BAR;2233BW,,ABS HB,BK23,GLO	1	S.A	
...3	M0081	6003-000282	SCREW-TAPTITE;BH,+,-,B,M3,L8,ZPC(BLK),SW	2	S.N.A	
...3	T0524	6902-000023	BAG PE;LDPE,T0.08,W150,L120,TRP,-,-,-,1.	1	S.N.A	
...3		BN61-02786A	BRACKET-PLATE;PEBBLE,SECC,1.0	1	S.N.A	
...3		BN61-04251A	STAND-BAR;2233BW,ABS,HB,BK23,Glossy	1	S.N.A	
...3	CCM1	BN63-02183D	COVER-SHEET;Rhcm,PE Vinyl,T0.05,680mm,20	0.2	S.N.A	
..2	M0027	BN96-08556A	ASSY STAND P-BASE;Cream-MFM 18.5,ABS HB,	1	S.A	
...3	CIS4	BN61-01717A	HOLDER-STAND;BIZET,NI PLT,CH,+ ,M4,L11(5)	1	S.N.A	
...3	CCM1	BN63-02183C	COVER-SHEET;Rhcm,PE Vinyl,T0.05,200mm,20	1	S.N.A	
...3	T0132	BN73-00077A	RUBBER FOOT;MATISSE,BUMPON,Φ13.5,T2.0,6	4	S.N.A	
...3	M0081	6003-000282	SCREW-TAPTITE;BH,+,-,B,M3,L8,ZPC(BLK),SW	4	S.N.A	
...3		BN61-02785A	BRACKET-STAND BODY;PEBBLE,SECC,0.8	1	S.N.A	
...3	T0004	BN63-02881C	COVER-STAND BASE;LS19CF,ABS,HB,BK23	1	S.N.A	
...3	T0524	6902-000110	BAG PE;LDPE,T0.05,W250,L400,TRP,28,2,-,9	1	S.N.A	
..2	M0045	BN96-08749Z	ASSY ACCESSORY;LS19CMYKF/ZA	1	S.A	
...3	T0268	3903-000085	CBF-POWER CORD;DT,US,BP3/YES,I(IEC C13/C	1	S.A	
...3	T0524	6902-000110	BAG PE;LDPE,T0.05,W250,L400,TRP,28,2,-,9	1	S.N.A	
...3		BH68-00261F	MARK RECYCLE-CARD WARRANTY- 05;SyncMaster	1	S.N.A	
...3		BH68-00344C	MARK RECYCLE-03,WARRANTY CARD;SECA W'TY	1	S.N.A	
...3	M9889	BN63-02368B	CLOTH-CLEAN;cloth,120,160,sea blue,ToC	1	S.N.A	
...3	M0215	BN96-08746A	ASSY MANUAL P-IB+QSG;933SN,SYNCMAS T ER,w/	1	S.N.A	
....4		BN59-00791A	S/W DRIVER-00,IB;933SN,W/W,CREAM	1	S.N.A	
....4		BN68-01650A	MANUAL FLYER-QSG;COMM,W/W,Mojo 80g,148,2	1	S.N.A	
...3		BN96-08769A	ASSY HOLDER P-CABLE;CREAM,ELASTOMER HB,Y	1	S.N.A	
....4		6902-000336	BAG ZIPPER;LDPE,T0.05,W70,L80,TRP,-,-,-,	1	S.N.A	
....4		BN61-04324A	HOLDER-CABLE;CREAM,Urethane,YL01	1	S.N.A	
0.1	M0003	BN92-04034D	ASSY BOX;LS19CMYKF/ZA	1	S.N.A	
..2		BN69-02950C	BOX-02;933SN,CB,SW,A1,YEL,W508,D368,H105	1.02	S.N.A	